



**STATE OF MICHIGAN
COUNTY OF OAKLAND
CHARTER TOWNSHIP OF BLOOMFIELD**

**NOTICE OF PUBLIC HEARING
WETLANDS BOARD**

**THE ENCLAVE
14 MILE & TELEGRAPH ROAD
(SIDWELL NOS: 19-32-476-001, -002, AND PART OF -003)**

PLEASE TAKE NOTICE THAT the Wetlands Board of the Charter Township of Bloomfield, Oakland County, Michigan will hold a PUBLIC HEARING on **MONDAY, AUGUST 4, 2025, at 7:00 p.m.**, in the auditorium at the Bloomfield Township Hall, 4200 Telegraph Road, Bloomfield Hills, MI 48302. At the hearing, the Wetlands Board will review the Robertson Brothers Homes development project known as the Enclave. Focus will be made on the project's impact of onsite wetlands and the developer's mitigation plan.



Comments regarding this development may be provided at the public hearing, submitted via email to publiccomment@bloomfieldtp.org or by contacting the Planning Division at (248) 433-7795. Materials for the Wetlands Board hearing will be made available to the public on Bloomfield Township's [Documents of Demand webpage](#) by the close of business on Thursday, July 31, 2025. Meetings are broadcasted live through [Bloomfield Community Television](#) on Comcast's channel 15 for residents of Bloomfield Township. The links and Quick Response ("QR") codes provided above can be utilized to view the meeting's materials and proceedings.

**MARTIN C. BROOK
BLOOMFIELD TOWNSHIP CLERK**

NOTE: The Charter Township of Bloomfield will provide necessary, reasonable auxiliary aids and services at all meetings to individuals with disabilities. All such requests must be made at least five days prior to said meeting. Individuals with disabilities requiring auxiliary aids or services should contact Bloomfield Township by writing or calling the following: Letter • Bloomfield Township Clerk's Office, 4200 Telegraph Road, Bloomfield Hills, MI 48302. Email • clerk@bloomfieldtp.org Phone • 248-433-7702.

Post: 7-21-2025

Publish: 7-20-2025

US Mail: 7-21-2025

Mailing Map

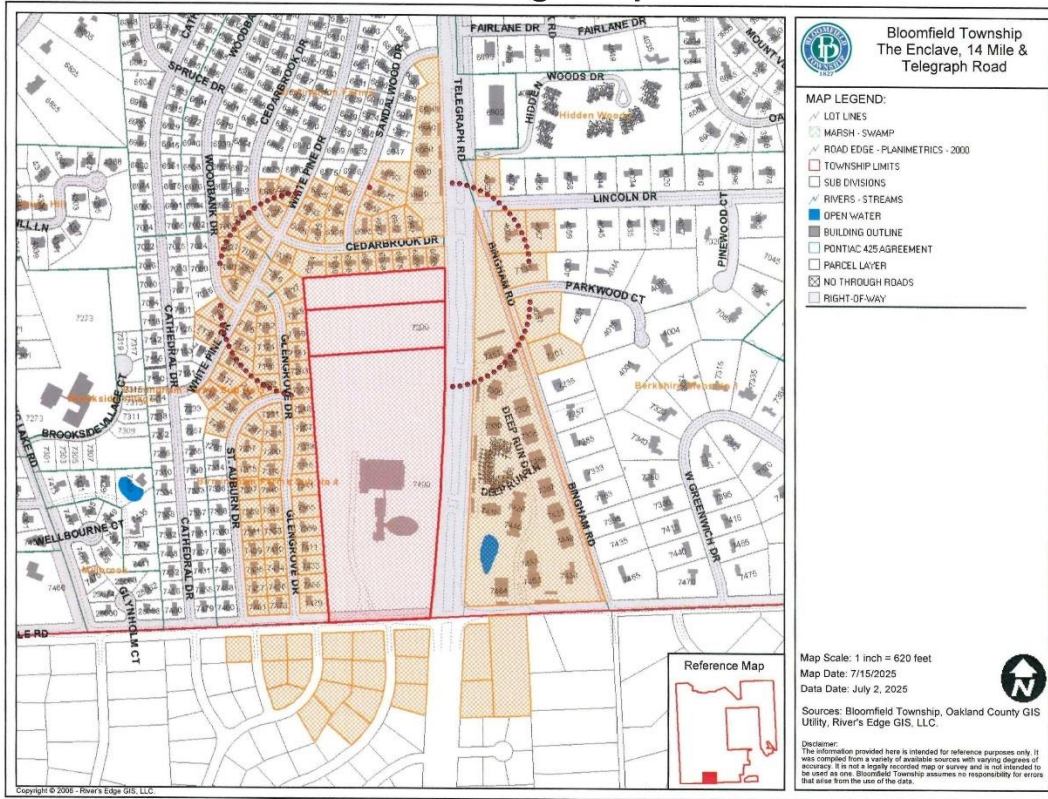

Graphic Showing the Impacted Wetlands:

